

Switch Cylinder

SZM 9212, SZM 9312



Configuration

Cylinder in brass, chrome plated
Reversible key made from nickel silver

Included with the cylinder

2 reversible keys
Kaba gemini S, quattro S and quattro pluS: plastic clip in Kaba blue
Kaba penta: plastic clip in dark red

Switch element

Type 9212: D2F, 125 VAC, 30 VDC
Type 9312: 250 VAC, 30 VDC (with plug contact)

Function

Switch cylinder with On/Off and/or signal function.
This cylinder has two surfaces for turning protection
Used in electrical devices.

Available systems

- | | | |
|-------------------------------------|------------------------------------|--------------------------------------|
| 6 Kaba penta | 7 Kaba quattro pluS | 2 Kaba gemini S |
| 4 Kaba quattro S | 5 Kaba experT ²⁾ | 9 Kaba gemini T ²⁾ |
| 3 Kaba quattro ¹⁾ | | 1 Kaba gemini ¹⁾ |

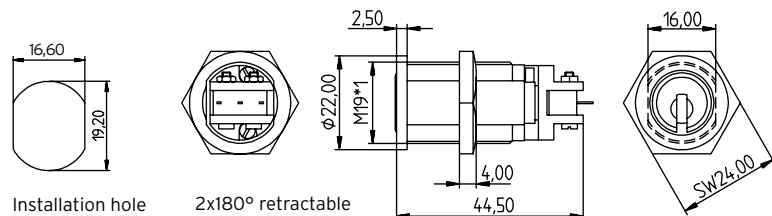

Order Code	Type	Function
*.SZM 9212.1x90.**	9212	On/Off switch, 1 retraction setting, rotation 90°
*.SZM 9212.l.**	9212	Signal switch, 1 retraction setting, rotation 90°
4.SZM 9212.2x180.**	9212	On/Off switch, 2 retraction settings, rotation 180°, only quattro S
*.SZM 9312.1x90.**	9312	On/Off switch, 1 retraction setting, rotation 90°
*.SZM 9312.l.**	9312	Signal switch, 1 retraction setting, rotation 90°
4.SZM 9312.2x180.**	9312	On/Off switch, 2 retraction settings, rotation 180°, only quattro S

* System code number (1, 2, 3, 4, 5, 6, 7, 9)

** Surface Finishes

Natural nickel	NI
Standard/natural brass	MS
Standard antique brass	MSA
Polished brass	MP
Chemically nickel-plated	NIC
Standard chrome	CR
Polished chrome	CRP
Dull chrome	CRM
Light brown	BH
Medium brown	BM
Brown, dark/black	BD
Gold plated	GO

¹⁾ The systems Kaba gemini and Kaba quattro are offered for expansions only!

²⁾ Kaba experT and Kaba gemini T systems are only sold to authorized dealers.

Switch Cylinder SZM 85-3-033



Configuration

Cylinder in brass, chrome plated
Reversible key made from nickel silver

Included with the cylinder

2 reversible keys
Kaba gemini S, quattro S and quattro pluS: plastic clip in Kaba blue
Kaba penta: plastic clip in dark red
1 fastening nut M23x1
1 switch element

Switch element

Micro switch 250 V / 5 A
2 channels (= 1 opener and 1 closer)

Function

Switch cylinder with fastening nut for key retraction setting in On or Off, or as signal switch.
For functions see "Order Code".

Available systems

6	Kaba penta	7	Kaba quattro pluS	2	Kaba gemini S
		4	Kaba quattro S		
		5	Kaba experT ²⁾	9	Kaba gemini T ²⁾
		3	Kaba quattro ¹⁾	1	Kaba gemini ¹⁾

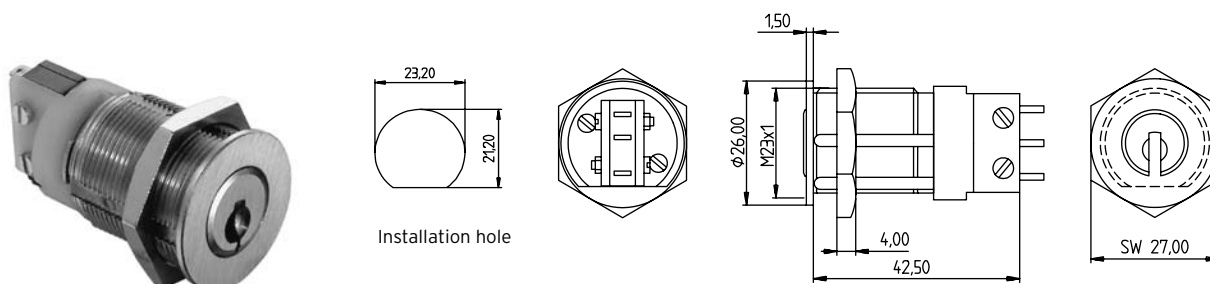

Order Code

*.SZM 85-3-033.1x90.**	On/Off switch, 1 retraction setting, rotation 90°
*.SZM 85-3-033.1x360.**	On/Off switch, 1 retraction setting, rotation 360°
*.SZM 85-3-033.1.**	Signal switch, 1 retraction setting, rotation 90°

* System code number (1, 2, 3, 4, 5, 6, 7, 9)

** Surface Finishes

Natural nickel	NI
Standard/natural brass	MS
Standard antique brass	MSA
Polished brass	MP
Chemically nickel-plated	NIC
Standard chrome	CR
Polished chrome	CRP
Dull chrome	CRM
Light brown	BH
Medium brown	BM
Brown, dark/black	BD
Gold plated	GO

¹⁾ The systems Kaba gemini and Kaba quattro are offered for expansions only!

²⁾ Kaba experT and Kaba gemini T systems are only sold to authorized dealers.